

1

2

3

4

5

6

7

Male

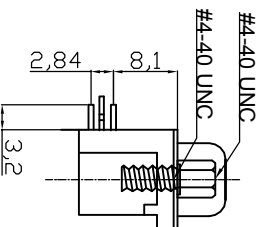
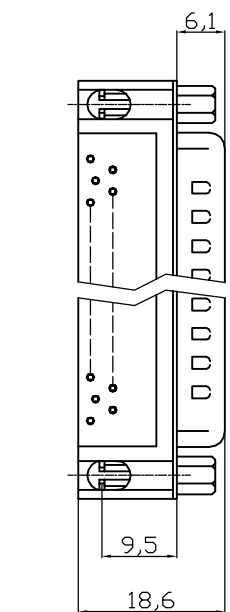
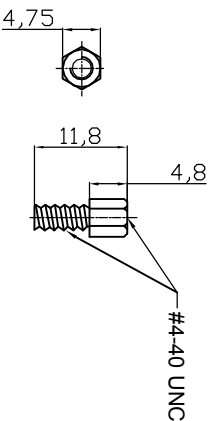
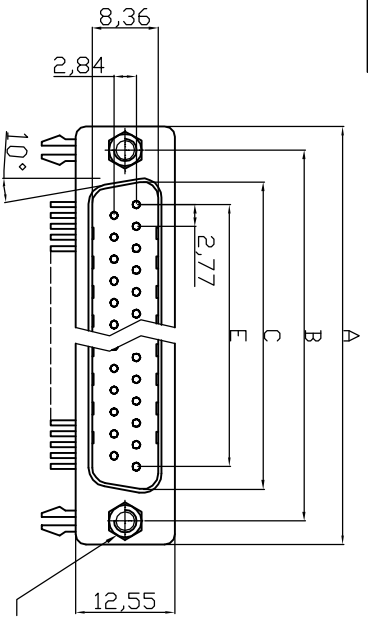

- NOTES:**
- MATERIAL**
1. Insulator Material: Glass-Filled Thermoplastic PBT, UL 94V-0, Black
 2. Contact Material: Brass
 3. Contact plating: Gold flash full gold
 4. Shell: Steel, 100u" Tin over 50u" min copper
 5. Clinch Nut: Copper alloy, Nickel plated
 6. Boardlock: Brass, Tin plated
 7. Screwlock: Steel, Nickel plated
- ELECTRICAL**
1. Current Rating: 3AMP
 2. Voltage Rating: 250V AC/rms 60Hz
 3. Contact Resistance: 20mΩ max at 1 AMP DC
 4. Insulation Resistance: 1000MΩ at 500 V DC
 5. Withstand Voltage: 1000V AC/rms 60Hz for 1 minute
 6. Operating Temperature: -55°C~+105°C
- UL No. E149426
- Order Code: A-Dx xx A/K-G-xx * on request
- Contact style: F - Female S - Male No. of Contacts 09 / 15 / 25 / 37
- Version: T2 - with locking bolts UNC (Gold flash full gold) T2S - with locking bolts UNC (Gold flash selective gold) T4 - without locking bolts *(Gold flash full gold) T4-2 - without locking bolts *(selective 15u"Au for 9&15 poles) T4S - without locking bolts *(Gold flash selective gold) Standard: Quality class III
- Ⓢ T2A - with UNC screw of 5.8mm.

7.2mm Footprint

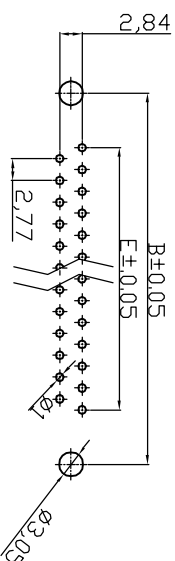

Dimensions

Positions	A	B	C	E
09	30.81	24.99	16.92	11.08
15	39.20	33.30	25.25	19.39
25	53.05	47.04	38.96	33.24
37	69.40	63.50	55.42	49.86

ROHS compliant
Unit: mm

Scale	Free				
TOLERANCE					
X.	±0.38	④	Add the specification :T2A	13.06.2016	Winnie
X.X	±0.25	③	Add the plating specification 15u"Au	05.03.2015	Winnie
X.XX	±0.13	②	Update the operating temperature	05.06.2014	Winnie
DIM	TOL	①	Update	24.10.2012	Winnie
X.°	±3°				
X.X°	±1.0°	①	Drawn	15.08.2012	Lucas
Angle	TOL		Modification		

Customer-No.

Date

Name

ASSMANN WSW-No.

A-Dx xx A/K-G-T2/T2S/T4/T4-2/T4S/T2A

Drawing-No.

ASS 4888 CO rev04



Replace

Sheet 1/2

1

2

3

4

5

6

7

H

G

F

E

D

C

B

A

Female

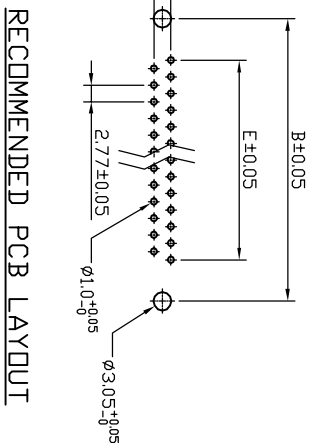
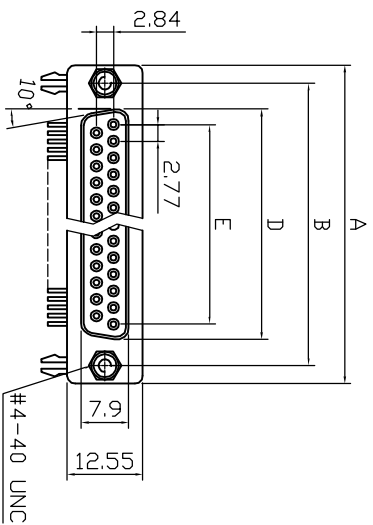

Product Specification

Material
 Insulator : Glass-Filled thermoplastic PBT UL 94V-0 Black
 Contact : Copper alloy
 Contact Plating : Gold flash full gold

Shell : Steel, 100u" Tin over 50u" min copper
Boardlock : Brass, Tin Plated
Screwlock : Steel, Nickel Plated

Electrical
 Contact Resistance : 20 milliohms Max at 1 AMP DC.
 Insulation Resistance : 1000 megohms at 500 VDC
 Dielectric Withstanding Voltage : 1000 VAC/rms 60Hz for 1 minute
 Current Rating : 3AMP
 Voltage Rating : 250 VAC/rms 60Hz
 Operating Temperature : -55°C+105°C
 UL No. E149426

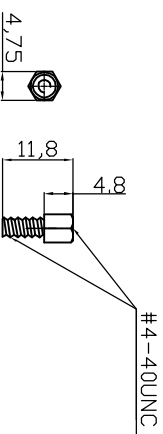
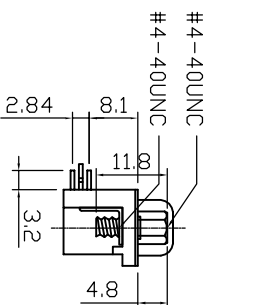
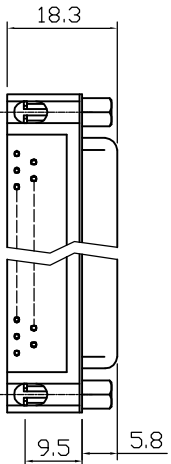

#4-40 unc screwlock installed

Dimensions

Positions	A	B	D	E
9	30.81	24.99	16.33	11.08
15	39.20	33.30	24.70	19.39
25	53.05	47.04	38.40	33.24
37	69.40	63.50	54.80	49.86

7.2mm Footprint

RoHS compliant
 Unit: mm

Scale	Free										
TOLERANCE											
X.	±0.38	④	Add the specification: T2A	13.06.2017	W/irnie	Drawn	15.08.2012	Lucas	ASSMANN WSW-No.	Customer-No.	
X.X	±0.25	③	Add the plating specification 15u" Au	05.03.2015	W/irnie	Approved	13.06.2017	W/irnie	A-DX xx A/KG-T2/T2S/T4/T4-2/T4S/T2A		
X.XX	±0.13	②	Update the operating temperature	05.06.2014	W/irnie				Drawing-No.		
DIM	TOL	①	Update	24.10.2012	W/irnie				ASS 4888 CO		rev04
X.°	±3°	①							Replace		Sheet 2/2
X.X°	±1.0°	①	Drawn	15.08.2012	Lucas						
Angle	TOL	Id.	Modification	Date	Name						



1	2	3	4	5	6	7	A
1	2	3	4	5	6	7	A
H	G	F	E	D	C	B	A